

PLAN NO. 553
 FOR THE IMPROVEMENT OF
TWENTY-THIRD STREET
 BETWEEN
 ARROWHEAD AVENUE & MOUNTAIN VIEW AVENUE
 IN THE
 CITY OF SAN BERNARDINO CALIFORNIA
 May 11 1929
 C. E. Johnson
 City Engineer

LEGEND
 --- means inch or inches
 - - - - - means feet or feet
 Concrete pavement to be constructed shown thus
 Concrete pavement in section shown thus
 Concrete walk to be constructed shown thus
 Concrete walk in section shown thus
 Concrete curbs to be constructed shown thus
 Concrete curbs in section shown thus
 Elev. means elevation

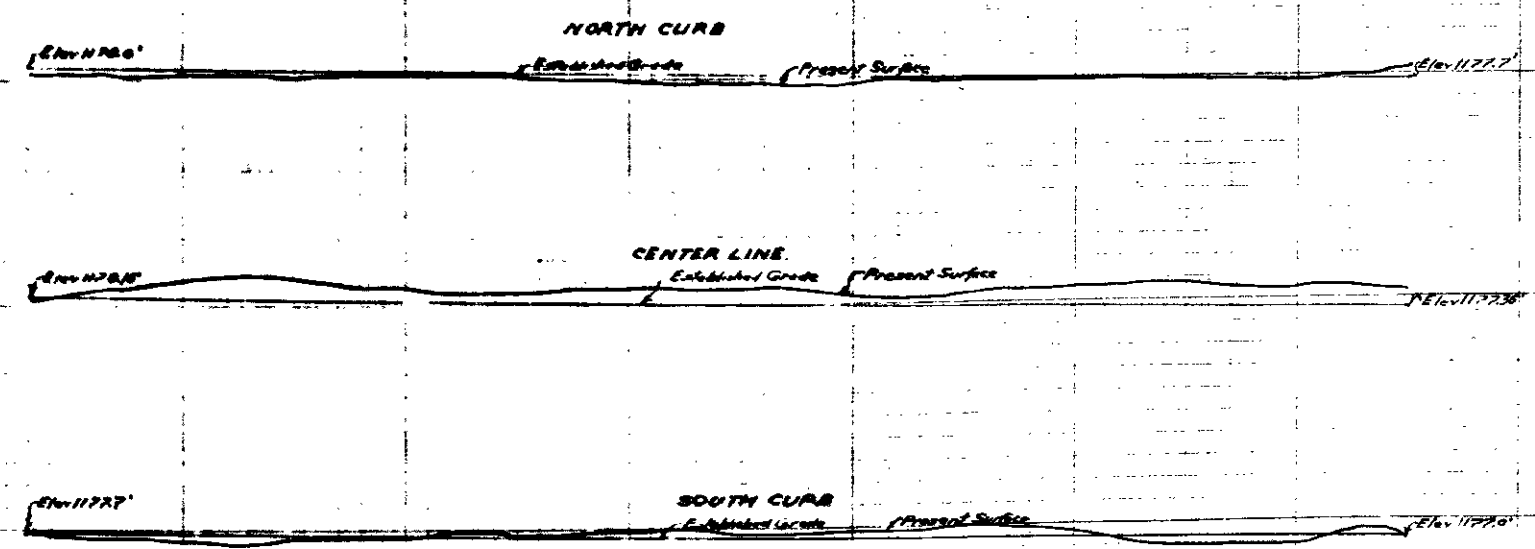
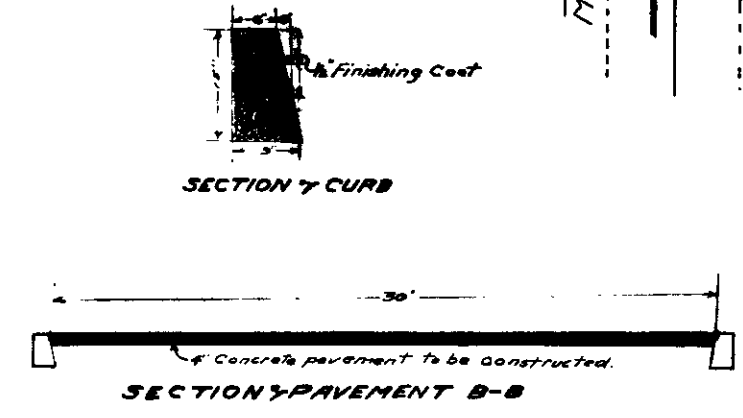
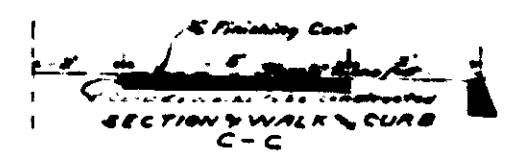
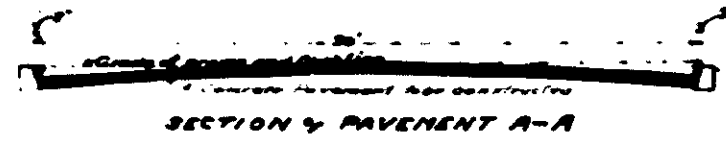
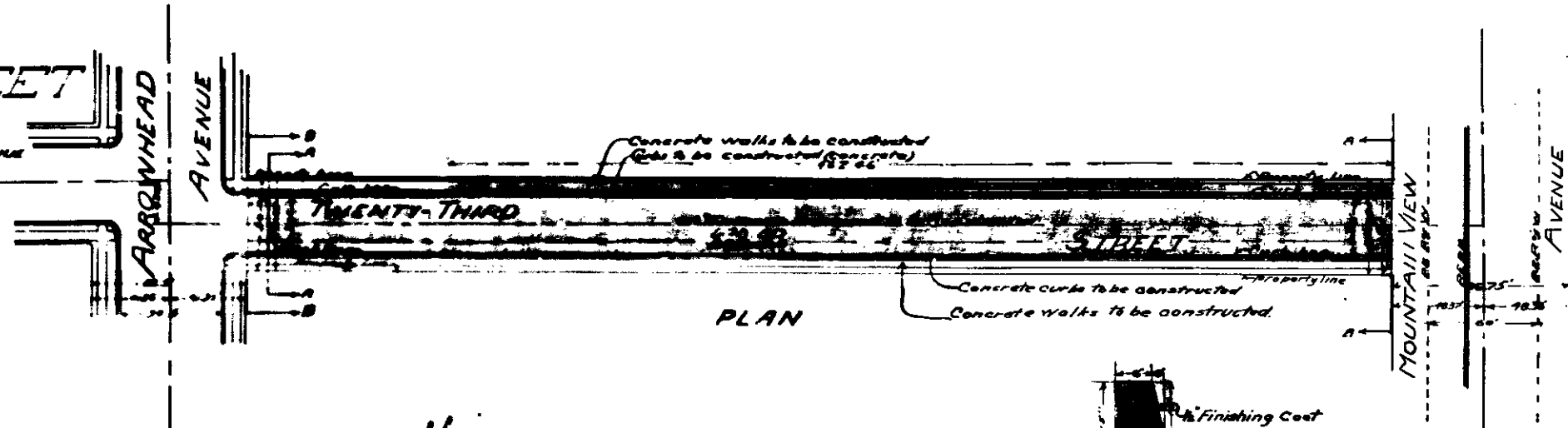

All elevations are in feet, and above
 a plane which is 100 feet below
 the City of San Bernardino as established
 by ordinance 11563 of the City of
 San Bernardino California

PROFILE
 BLACK LINES SHOW PRESENT SURFACE
 RED LINES SHOW ESTABLISHED GRADE

PLAN NO. 253
 FOR THE IMPROVEMENT OF
TWENTY-THIRD STREET
 BETWEEN
 ARROWHEAD AVENUE & MOUNTAIN VIEW AVENUE
 IN THE
 CITY OF SAN BERNARDINO CALIFORNIA
 May 11 1923
 C. E. Johnson
 City Engineer

LEGEND
 --- means inch or inches
 - - - - - means feet or feet
 Concrete pavement to be constructed shown thus
 Concrete pavement in section shown thus
 Concrete walk to be constructed shown thus
 Concrete walk in section shown thus
 Concrete curbs to be constructed shown thus
 Concrete curbs in section shown thus
 Elev. means elevation

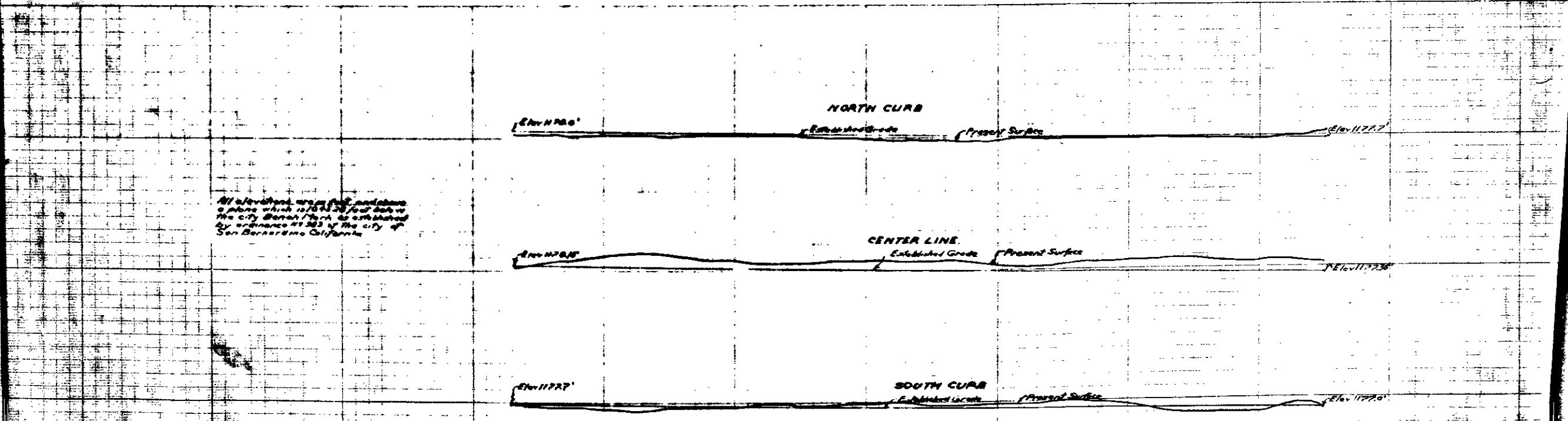
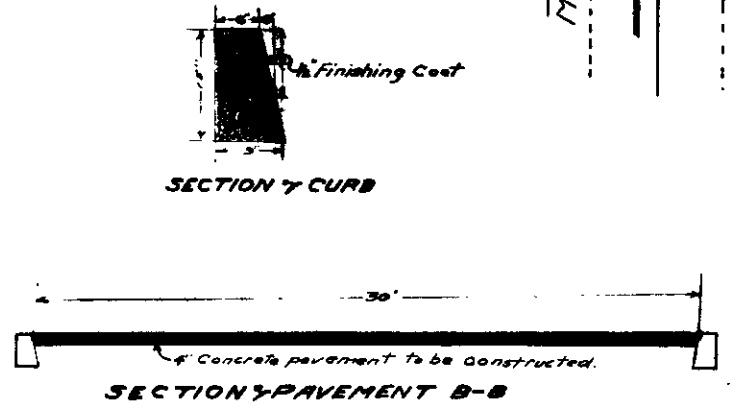
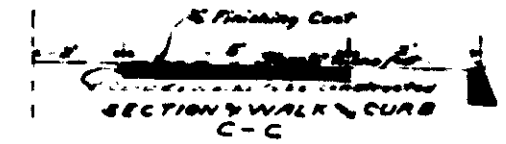
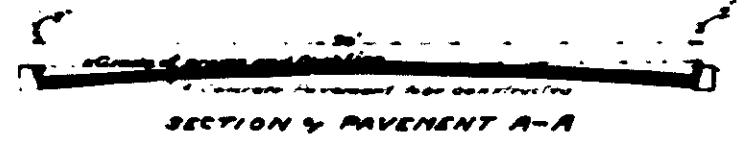
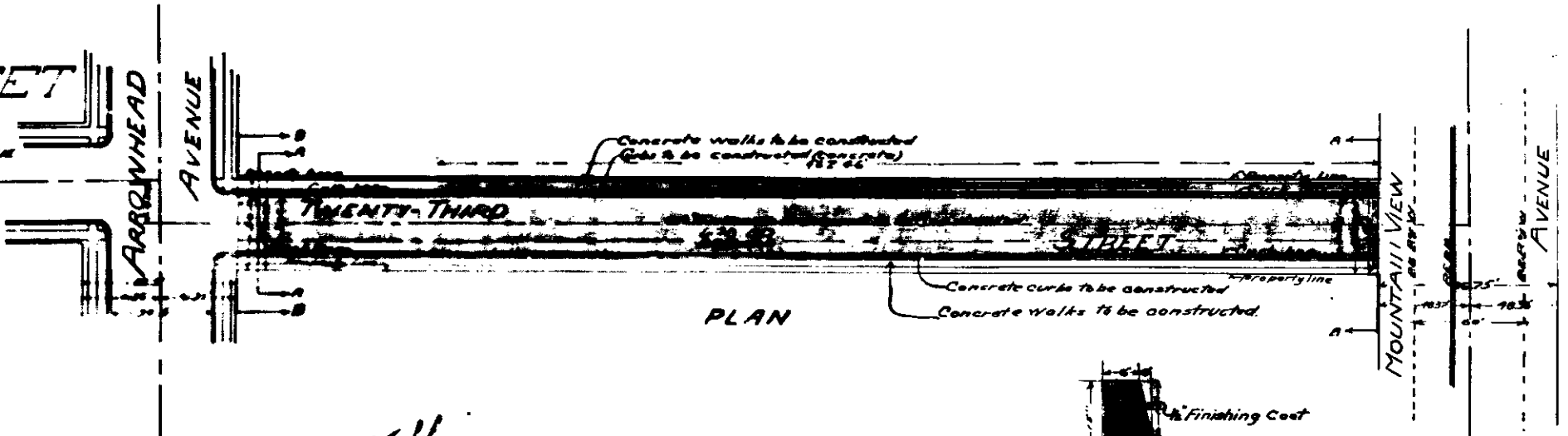

All elevations are in feet and above
 a plane which is 100 feet below
 the City of San Bernardino as established
 by ordinance 11523 of the City of
 San Bernardino California

PROFILE
 BLACK LINES SHOW PRESENT SURFACE
 RED LINES SHOW ESTABLISHED GRADE